

Modular Version Of MX Valves — Same Function, But Modern Design.

The “big brother” of the MSP. Uses same performance indicators as MSP!

Built-In Outlet Check Valves

Ensure accurate lube delivery, every time.

Indicator Ports

Alternate outlets on face of each valve can be fitted with optional performance indicators, taking the guesswork out of troubleshooting.

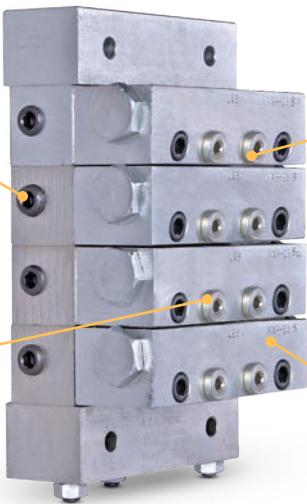

Easily Accessorized

Accessories such as proximity switch cycle indicators provide positive assurance of a successful lube event.

Quick Change Valve Sections

Easily removed from the base assembly without disturbing any lube lines.

Typical Applications

- Pulp and paper, steel mills, heavy- and high-volume industrial applications

Typical Fluids

- Oil or Grease up to NLGI #2

Technical Specifications

Material	Plated Steel
Maximum Pressure	3,000 psi (207 bar)
Maximum Operating Temperature	350°F (176°C)
Maximum Cycle Rate with Cycle Pin	60 cycles/min
Maximum Cycle Rate without Cycle Pin	110-200 cycles/min (see chart below)
Instruction Manual	312497

MXP Maximum Cycle Rates without Cycle Pin (cycles/min)

		Number of Sections							
		3	4	5	6	7	8	9	10
Smallest Piston in the Assembly	MXP-150	200	200	200	200	200	200	180	165
	MXP-125	200	200	200	200	200	195	175	155
	MXP-100	200	200	200	200	200	185	165	150
	MXP-75	200	200	200	200	200	175	155	140
	MXP-50	200	200	200	200	195	165	145	130
	MXP-25	200	200	200	200	165	140	125	120

## Steps to Build Your MXP Divider Valve System:

**A** Build Your Base Plate Assembly From the Chart Below

**B** Select Valve Working Sections

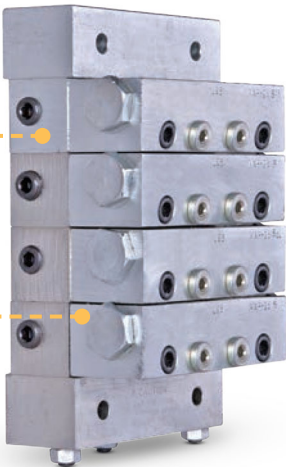

**Choose from Optional Accessories**

**C** Cross-port and Singling Bars

**D** Performance Indicators

**E** Cycle Indicators and Proximity Switches

**F** Mounting Bars

## A Ordering Information

### Build Your Own MXP Base Plate Assemblies

How many sections are in the assembly? This includes working sections and bypass blocks. Count up the number of sections and order at least one Intermediate Base Plate for each section. Then add one Inlet and one End section. Finally choose the correct tie rods and order three of them and also three nuts.

Item	Component	Description	Part Number			Note
			NPSF	BSPP	SAE-ORB	
1	Inlet section option	Includes one threaded port	15R993 (3/8-18)	561029 (3/8-19)	15R994 (3/4-16)	Must be ordered in multiples of 5
2	Intermediate base plate	Standard base with outlet checks	563519 (1/4-18)	563522 (1/4-19)	563521 (9/16-18)	
		"MXPO" base, no outlet checks	563527	24Z675	N/A	
3	End section options	Standard	563518			
4	Tie rods (3 required)	3-section	557766			3 tie rods and tie rod nuts required for assembly
		4-section	557767			
		5-section	557768			
		6-section	557769			
		7-section	557770			
		8-section	557771			
		9-section	557772			
		10-section	563520			
5	Tie rod nuts (3 required)	Tie rod nuts	555406			

### Legend

1	Inlet Section
2	Intermediate Base Section / Subplate
3	End Section
4	Tie Rod
5	Tie Rod Nut
6	MXP Valve Section
7	Outlet Port Plug
8	Cross-port or Singling Bar
9	Performance Indicator

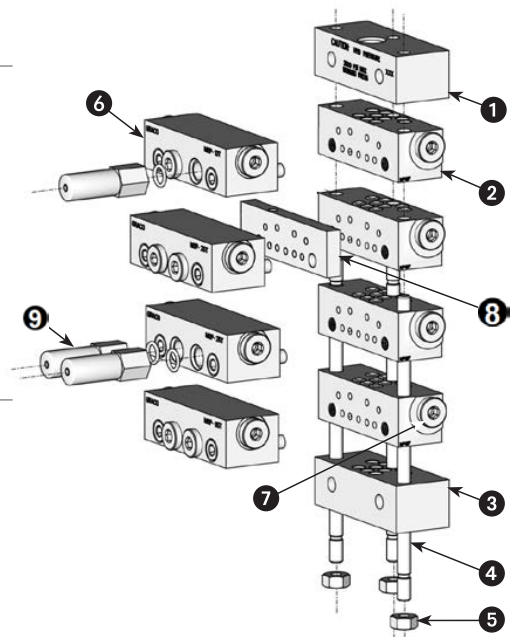

### MXP Section Spare Parts

Part Number	Description
115010*	Standard O-ring (90 DURO Fluoroelastomer), black
563917	Cycle indicator pin repair kit
556328	Outlet check ball
557484	Outlet check spring, NPSF and BSPP bases
556997	Outlet check spring, SAE-ORB bases

\*Part numbers are for a single O-ring; each section requires nine O-rings.

## B Ordering Information

### MXP Valve Sections

Also called “working” sections. Must be ordered in multiples of 2.

Outlet Configuration	Description	Output Per Outlet, in <sup>3</sup> (cm <sup>3</sup> )	Part Number	
			Standard Section	With Cycle Pin – Right
Single	MXP-25S*	0.050 (0.82)	562819	N/A
	MXP-50S*	0.100 (1.64)	562820	562830
	MXP-75S*	0.150 (2.46)	562821	562831
	MXP-100S*	0.200 (3.28)	562822	562832
	MXP-125S*	0.250 (4.10)	562823	562833
	MXP-150S*	0.300 (4.92)	562824	562834
Twin	MXP-25T	0.025 (0.41)	562813	N/A
	MXP-50T	0.050 (0.82)	562814	562825
	MXP-75T	0.075 (1.23)	562815	562826
	MXP-100T	0.100 (1.64)	562816	562827
	MXP-125T	0.125 (2.05)	562817	562828
	MXP-150T	0.150 (2.46)	562818	562829

\*Each “S” section uses only one outlet, but each intermediate base has two outlets. For each “S” section in the assembly, order one Outlet Port Plug (below), to plug the unused outlet.

### Outlet Port Plugs

Part Number		Note
NPSF	BSPP	
557391 (NPT)	556427 (with seal ring)	1 outlet port plug is required for each “S” valve section.

## C Ordering Information

### Cross-port and Singling Bars

Part Number	Component	Note
563525	Right Cross-port Bar	1 outlet port plug is required for each cross-port bar
563524	Left Cross-port Bar	
563526	Right and Left Cross-port Bar	2 outlet port plugs are required for each double cross-port bar

D

Ordering Information

Performance Indicators

These vital safeguards react to excess lube pressure when points or lines become blocked. Installed in indicator ports on the working piston sections, they quickly identify the affected lines.

Reset Indicators with Memory

Features and Benefits

- Provides quick troubleshooting tool with visual indication
- No tools for reset or parts to replace after indication
- Easy information on blocked lines, high system pressure or blocked bearings
- 1/8 NPSF thread with O-ring seal

Image Coming Soon	Part Number	Cracking Pressure
	563252	250 psi (17 bar)
	563253	500 psi (35 bar)
	563254	750 psi (52 bar)
	563255	1,000 psi (69 bar)
	563256	1,500 psi (103 bar)
	563257	2,000 psi (138 bar)
	563258	2,500 psi (172 bar)
	563261	3,000 psi (207 bar)

Automatic Relief Indicators

Features and Benefits

These performance indicators pinpoint lube line blockages but allow the lube system to continue to supply lubrication to points that are not blocked.

- Allows machine to continue to run when non-critical bearings are blocked
- No time or effort required for reset after blockage is cleared
- Easy information on blocked lines, high system pressure or blocked bearings
- 1/8 NPSF thread with O-ring seal

	Part Number	Cracking Pressure
	563170	750 psi (52 bar)
	563171	1,000 psi (69 bar)
	563172	1,250 psi (86 bar)
	563173	1,500 psi (103 bar)
	563174	2,000 psi (138 bar)
	563175	2,500 psi (172 bar)
	563176	3,000 psi (207 bar)

Performance Indicator Spare Parts

Part Number	Description
556569	Standard O-ring (90 DURO Fluoroelastomer), black
16U217	Indicator Port Plug, with O-ring 556569

Series Progressive

## E Ordering Information

### Cycle Indicators and Proximity Switches

A wide variety of safeguards monitor and verify lube cycles. These switches sense the divider valve piston's action for accurate control and monitoring of lube cycles.

	Part Number	Component	Description
	563260	Magnetic Visual Cycle Indicator	The highly visible cycle indicator has a snap-action movement which allows the user to visually determine the timing of each divider valve cycle.
	563272	Single Pole, Double Throw (SPDT) Standard Cycle Switch and Bracket Assembly	Used in conjunction with the cycle indicator pin at cycle rates not exceeding 60 cpm, the switch provides an electrical signal to the system controller which counts cycles to monitor and verify completion of the lube cycle. Included bracket clamps to spud around cycle pin.
	563273	Moisture-resistant SPDT Cycle Switch and Bracket Assembly	
	564357	Double Pole, Double Throw (DPDT) Cycle Switch and Bracket Assembly	
	17L880	Solid State Proximity Switch (see page 161 for mating cables)	This rugged switch has no moving parts, making it ideal for applications such as metal stamping presses and yellow iron equipment. 10-32 VDC PNP switching, M12 electrical connector, 200 cpm, 7,500 PSI (518 bar) maximum pressure. 50,000,000 cycle life, IP65, IP68, IP69 rated.
	563476	Field-Sensitive Proximity Switch, 3-Pin BH, with O-ring	A ceramic-magnet switch for grease or oil systems up to 200 cpm at pressure up to 3,500 psi (241 bar), accurately signals piston cycles, and is ideal for high-cycle applications. Bradley-Harrison (BH) electrical connectors, 115 VAC.
	564399	Field-Sensitive Proximity Switch, 5-Pin BH, with O-ring	

### Proximity Switch Spare Parts

Part Number	Component
556572	Standard O-ring (90 DURO Fluoroelastomer), black
557774	Enclosure Port Plug, requires O-ring 556572 (not included)

## F Ordering Information

### Mounting Bars

Part Number	Component	Description
561102	MXP/MX Mounting Bar	For welding to uneven metal surfaces. Two sets of mounting holes are threaded 5/16-18 to attach MXP or MX. This part is one individual bar, so order quantity 2 when needed.